

Components & Hardware

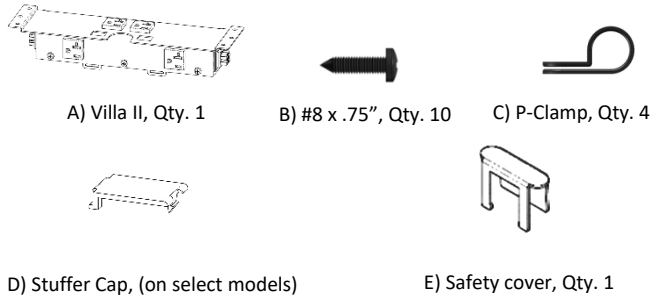

Tools Needed



Note: *Take care not to pierce finished surfaces. ECA System 42 connectors have been evaluated to prevent inadvertent contact with live parts. Connector openings are not required to be covered; however a cover is provided for use if desired, see detail below.

- 1- Locate and cut the hole for the Villa II. Prepare pilot holes as needed.*

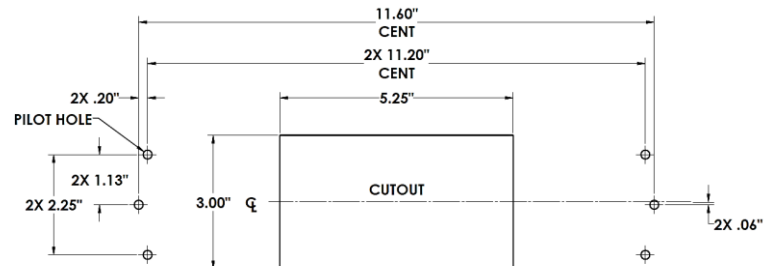

- 2- Mount Villa II (A) beneath the cutout. Secure with screws (B)* and position as needed. Do not use provided screws on table thicknesses less than 1.00".

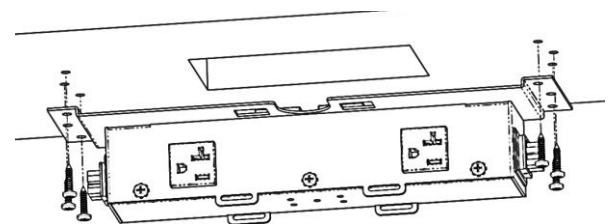

- 3- Connect power cables as shown. Connect all data cabling, if provided, as needed.

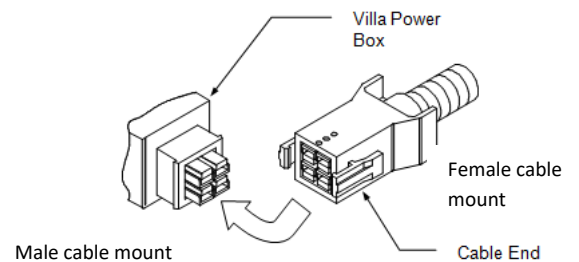

- 4- Slide safety cover (E) onto open male cable mount if desired.

Line up similar colors
And snap together connectors as shown

Plug into an appropriate outlet that is properly installed and grounded in accordance with all local codes and regulations.

