

INTERACT JR INSTALLATION

Components & Hardware

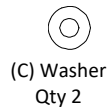

Tools Needed

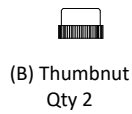
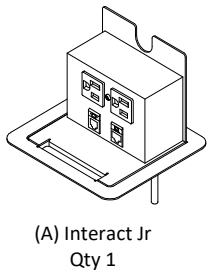

For use with: Table thickness up to 1.25"

- 1-** Provide cutout, at location Interact Jr (A) will be mounted.
- 2-** Insert Interact Jr into cutout from above work surface and secure with washers (B) and thumbnuts (C) as shown.
- 3-** If no data/phone is required proceed to Step 5.
- 4-** Some data/phone jacks can be installed from outside of Interact Jr housing while others will require access to inside housing. Flip up Interact Jr and follow instructions below as required.

4A – Outside jack install – Feed data/phone cable up thru data cord opening on underside of Interact Jr and out jack cutout. Make connection to jack as required and press jack into metal to seat.

4B - Inside jack install – Remove housing screws on underside of Interact Jr and lift housing straight up to disengage from bezel assembly. Feed data/phone cable up thru data cord opening on underside of Interact Jr. Make connection to jack as required and insert into metal from inside to seat. Slide housing back down onto bezel assembly and reinstall screws. Note: Be sure to engage lip in top of housing with catch on bezel assembly.

- 5-** Connect power cord as needed.

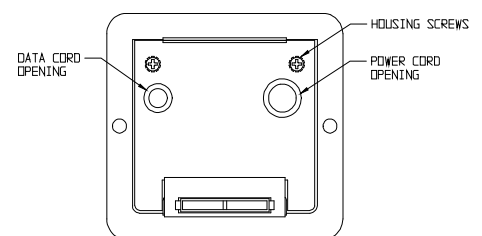
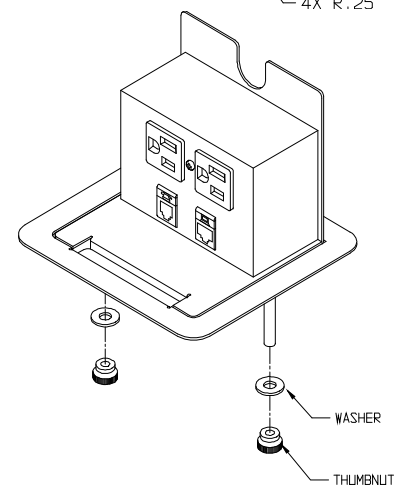
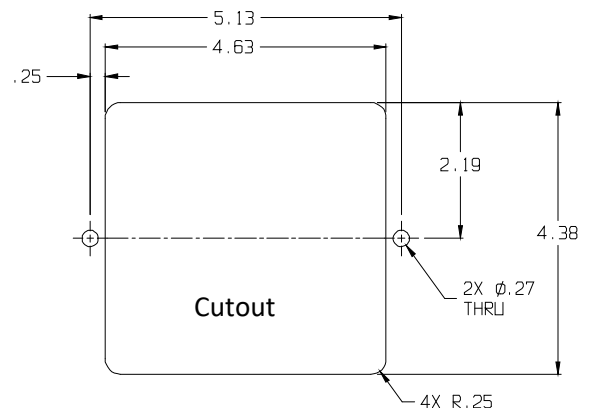

Underside of Interact Jr