



DESCRIPTION

The L350 Wall luminaire is a low-profile, lensed compliment to the L300 and L400 pendant series luminaire. Configured for either individual or continuous runs, the L350 Wall offers a partially curved design with a flat underside making it a great choice for your lighting projects in open and private offices, educational facilities, retail, or other applications.

SPECIFICATIONS

Housing:	20 gauge cold-rolled steel construction
Lengths:	4' and 8' fixtures that can also be joined for continuous rows
Finish:	Durable, low gloss, textured powder coated finish
End Caps:	Flat end cap provides a clean finish
Approvals:	UL/CUL
LED Engine:	Dimming driver and LED board combination
Optional Drivers:	Lutron, Osram, EldoLED and other options available
Distribution:	Standard 70/30 with optional distributions available
Optic:	Frosted Lens creates a smooth downlight feature
Output Package:	Super saver, high output, and very high output lumen levels available
Sensor:	Optional integrated daylight or occupancy sensors
LED Color:	Available color temperatures of 3000k, 3500k, and 4000k
Mounting:	Wall brackets included with fixture (2 per 4' or 3 per 8')
Battery:	Optional 12 watt constant power emergency battery
CRI:	82+
I.E.S. Data:	Available upon request
Warranty:	5-Year limited warranty

PHOTOMETRICS

* Measurements based on High level output

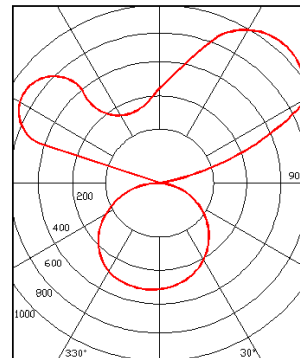

70/30 – Standard
3927 lumens
72% up - 28% down
106 lm/W



FIXTURE OPTIONS

Ordering Example: L350W-4-30-120-HO-WHT

FIXTURE SERIES	LENGTH	LED COLOR	VOLTAGE	OUTPUT	DISTRIBUTION TYPE	EMERGENCY CIRCUIT	FINISH	INTEGRATED SENSOR	OPTIONS
L350W Lens	4 8	30 3000k 35 3500k 40 4000k 50 5000k	MVO 120-277v 120 120v 277 277v 347 347v	SS Super Saver HO High Output	Blank Standard	Blank None EF Separate individual emergency feed EHF Emergency through wiring with separate feed EHS Emergency through wiring single feed with shared neutral	WHT * Consult factory for custom colors	Blank None DAY Daylight OCC Occupancy * Consult factory for Lutron, ELdoLED, Osram, or other drivers	Blank None FF Fast blow fuse FS Slow blow fuse EB Emergency battery EC Emergency circuit

* END CAP KIT: L350W -WHT (One kit required per fixture run)

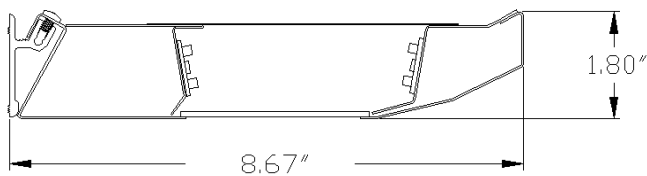

4' Output Package	Lumens	Watts	Lumens/Watt
Super Saver (SS)	2794	26	107
High Output (HO)	3927	37	106

* Based on 4000k

MOUNTING SUPPORT LENGTHS

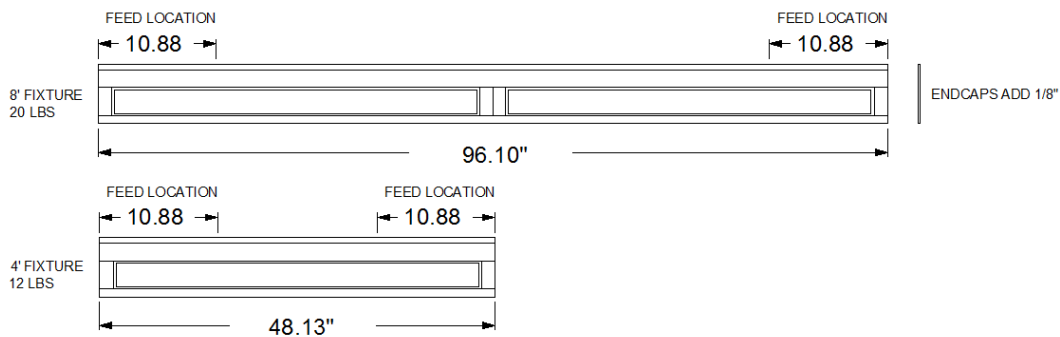

MOUNTING HARDWARE

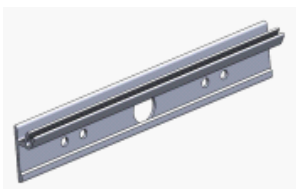

WALL BRACKETS INCLUDED

