

# DEKKO

7310 Innovation Blvd. Suite 104  
Fort Wayne, IN 46818  
Customer Service: 800.357.5622

## COVE

Daisylink  
Installation Instruction

This device complies with part 15A of the FCC Rules. Operation is subject to the following two conditions: (1) This device may not cause harmful interference, and (2) this device must accept any interference received, including interference that may cause undesired operation.

### Tools Required

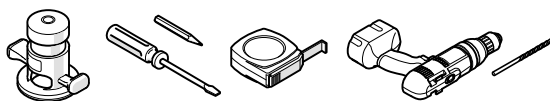

## 1 Determine The Surface Cutout Size for the COVE Unit Being Installed

### \* NOTE \*

Refer to chart to determine "X" dimension. (Max radius on corners is R 5/16in)

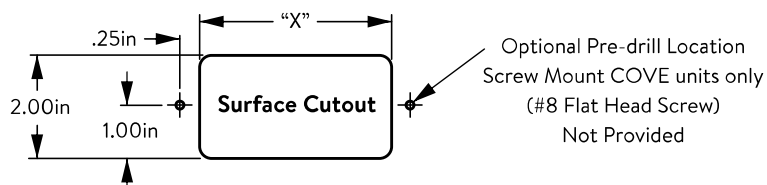

Standard Faceplate	"X"	Data Faceplate	"X"
2 Power	4.50in	2 Power	8.25in
2 Power 1 Convenience	5.25in	2 Power 1 Convenience	9.00in
3 Power	5.75in	3 Power	9.50in
4 Power	7.25in	4 Power	11.00in
6 Power	12.25in	6 Power	16.00in
USB Only 60W A&C	4.50in	USB Only 60W A&C	8.25in
1 Power / 60W USB A&C	5.25in	1 Power / 60W USB A&C	9.00in
2 Power / 60W USB A&C	6.75in	2 Power / 60W USB A&C	10.50in
3 Power / 60W USB A&C	8.00in	3 Power / 60W USB A&C	11.75in
4 Power / 60W USB A&C	9.50in	4 Power / 60W USB A&C	13.25in
5 Power / 60W USB A&C	11.00in	5 Power / 60W USB A&C	14.75in
6 Power / 60W USB A&C	12.75in	6 Power / 60W USB A&C	16.50in

## 2 Install COVE Assembly into Cutout opening

### \* NOTE \*

Standard clamp fits surface thicknesses .25in to 1.25in. Surfaces with a thickness between 1.25in and 1.50in need an alternate bracket which is sold separately and used for clamping the COVE which is shown in step 3.

### Clamp Mounting

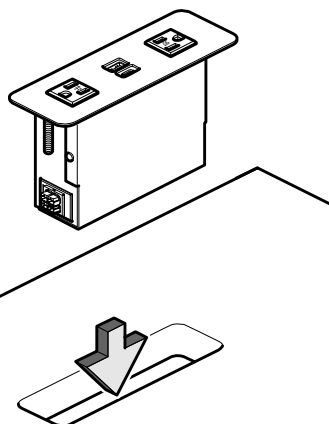

### Screw Mounting

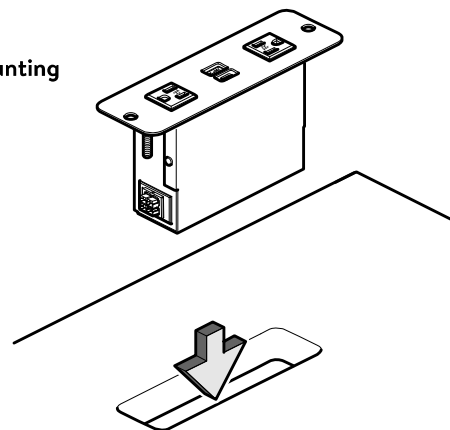

## 3 Secure COVE Assembly to Worksurface

### Clamp Mounting

Bottom side of Worksurface

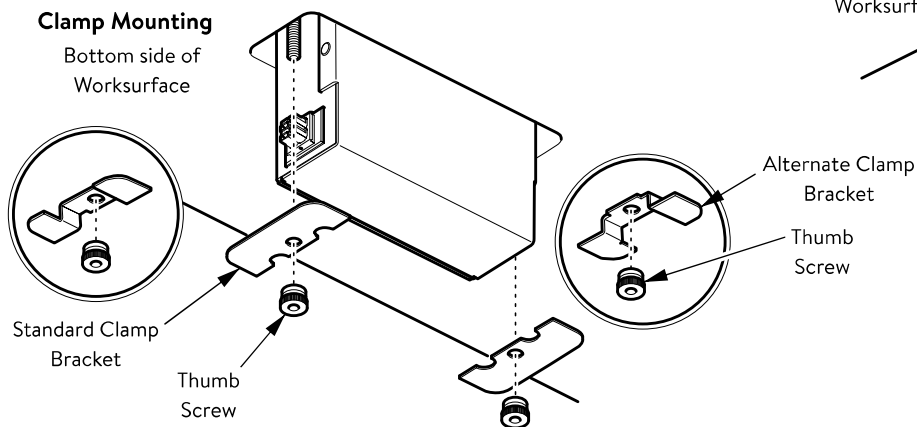

### Screw Mounting

Top side of Worksurface

Screws Not Provided

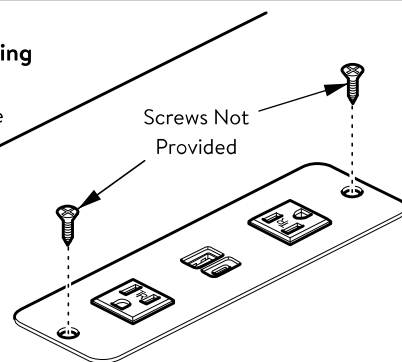

### \* NOTE \*

Tighten screws until secure, do not over tighten.

# DEKKO

7310 Innovation Blvd. Suite 104  
Fort Wayne, IN 46818  
Customer Service: 800.357.5622

## COVE

Daisylink  
Installation Instruction

This device complies with part 15A of the FCC Rules. Operation is subject to the following two conditions: (1) This device may not cause harmful interference, and (2) this device must accept any interference received, including interference that may cause undesired operation.

### Tools Required

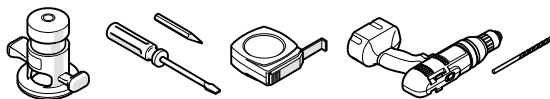

## 4A

### Connect the installed COVE units with Provided Cables

#### \* NOTE \*

Use P-Clamp and screw to secure conduit to bottom of worksurface.

(Clamp Mounting)  
COVE Unit Shown

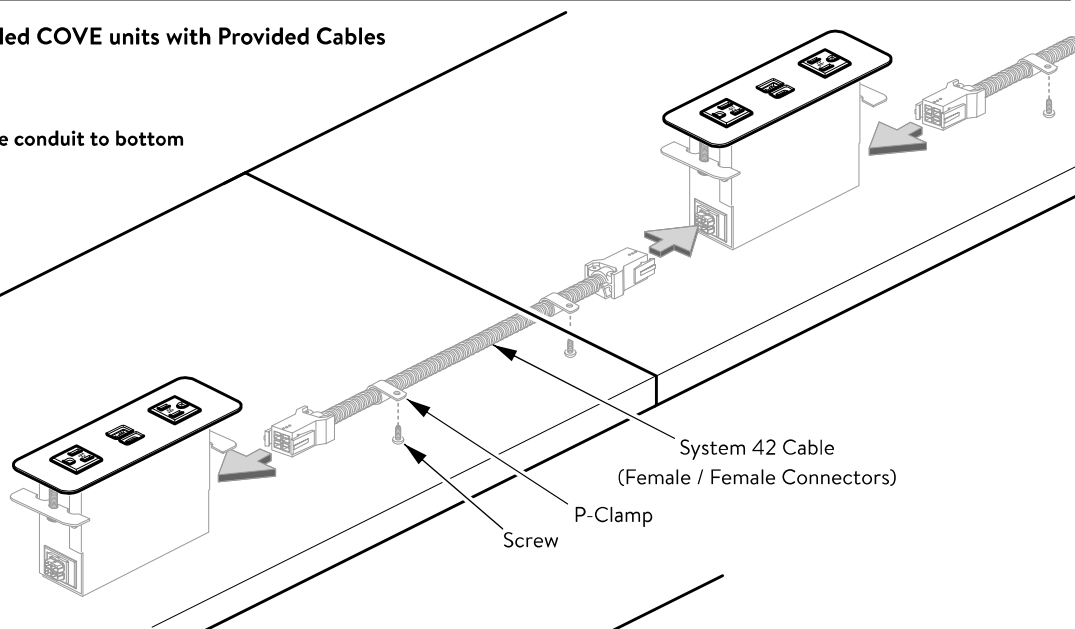

## 4B

### Connect the desired Power In-feed into the first COVE unit and Connect Power and Data as needed.

#### \* NOTE \*

Use P-Clamp and screw to secure conduit to bottom of worksurface.

#### \* NOTE \*

Plug into an appropriate outlet that is properly installed and grounded in accordance with all local codes and regulations.

#### \* NOTE \*

A licensed electrician should make the hardwire connections. For use on dry work surfaces or furniture only. No serviceable parts, do not disassemble.

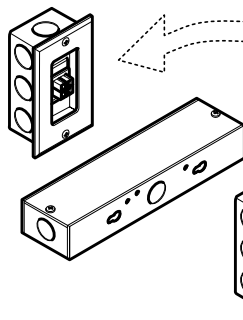

#### WIRE DESIGNATION

Bare/Green Wire - (Circuit Ground)  
White Wire - (Circuit Neutral)  
Black Wire - (Circuit Hot)

## 4C

### Install Safety Cover on Last COVE Unit to Protect from Electrical Shock

