



BY DEKKO

2505 Dekko Drive
Garrett, IN 46738
Customer Service: 800.357.5622

ASHLEY DUO BEZEL

- Corded -
Horizontal & Vertical Surface Mounting
Installation Instruction

This device complies with part 15A of the FCC Rules. Operation is subject to the following two conditions: (1) This device may not cause harmful interference, and (2) this device must accept any interference received, including interference that may cause undesired operation.

Tools Required

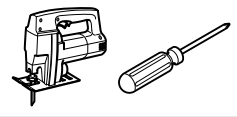

1 Cutout Opening for Ashley Duo Bezel Assembly

*** NOTE ***
Max Radius on Cutout Corners is 1/4"

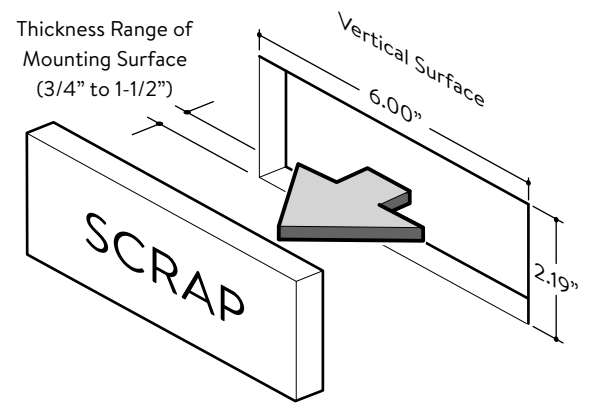

2 Install Ashley Duo Bezel Assembly into Cutout

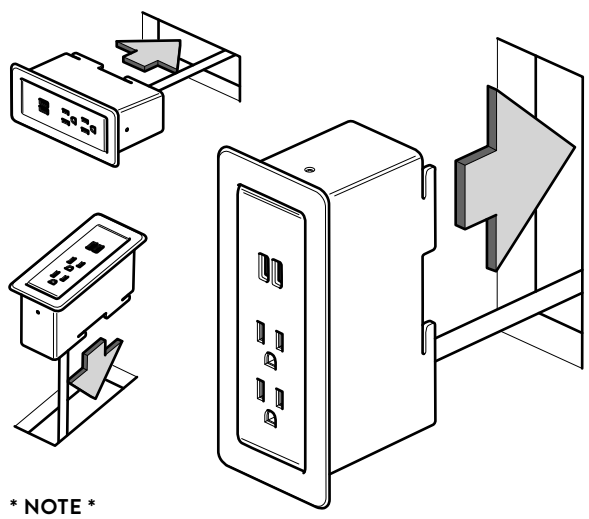

*** NOTE ***
Tabs Point Up when Unit is Installed Vertically - See Vertical Orientation

3 Install Retainer Bracket

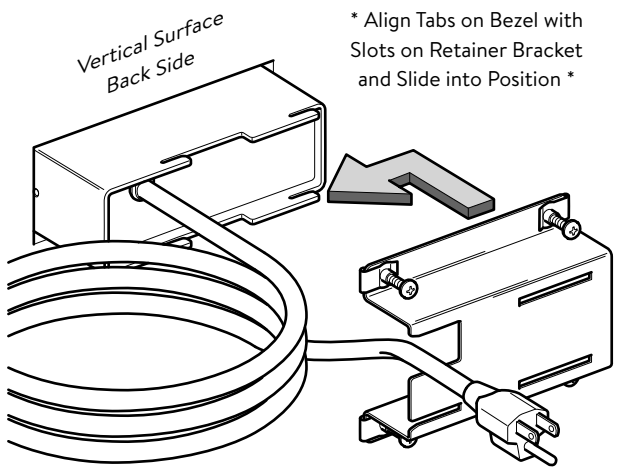

* Align Tabs on Bezel with Slots on Retainer Bracket and Slide into Position *

*** NOTE ***
Route Power Cord Through Notch in Retainer Bracket

4 Route Power Cord to Nearest Power Distribution Source

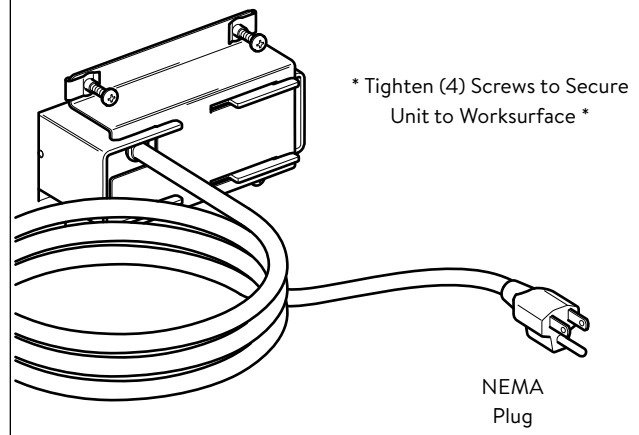

* Tighten (4) Screws to Secure Unit to Worksurface *

STUDIO

BY DEKKO 2505 Dekko Drive
Garrett, IN 46738
Customer Service: 800.357.5622

ASHLEY DUO BEZEL

- Corded -
Horizontal & Vertical Surface Mounting
Installation Instruction Template

This device complies with part 15A of the FCC Rules. Operation is subject to the following two conditions: (1) This device may not cause harmful interference, and (2) this device must accept any interference received, including interference that may cause undesired operation.

