

VILLA II INSTALLATION

Components & Hardware

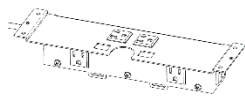

A) Villa II, Qty. 1



B) #8 x .75", Qty. 10



C) P-Clamp, Qty. 4

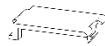

D) Stuffer Cap, (on select models)

Tools Needed



Note: *Take care not to pierce finished surfaces.

1- Locate and cut the hole for the Villa II. Prepare pilot holes as needed.*

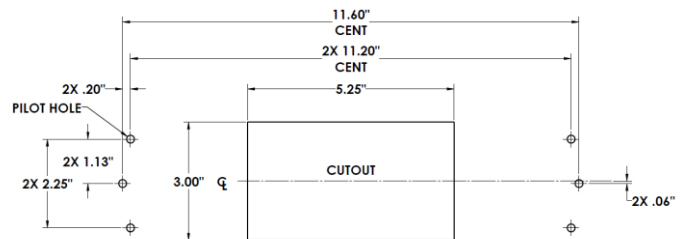

2- Mount Villa II (A) beneath the cutout. Secure with screws (B)* and position as needed. Do not use provided screws on table thicknesses less than 1.00".

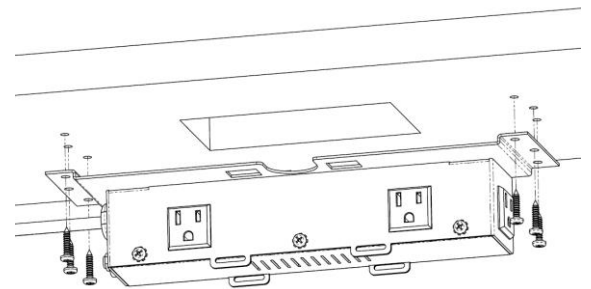

3- Connect all power and data cabling as needed.

Plug into an appropriate outlet that is properly installed and grounded in accordance with all local codes and regulations.